

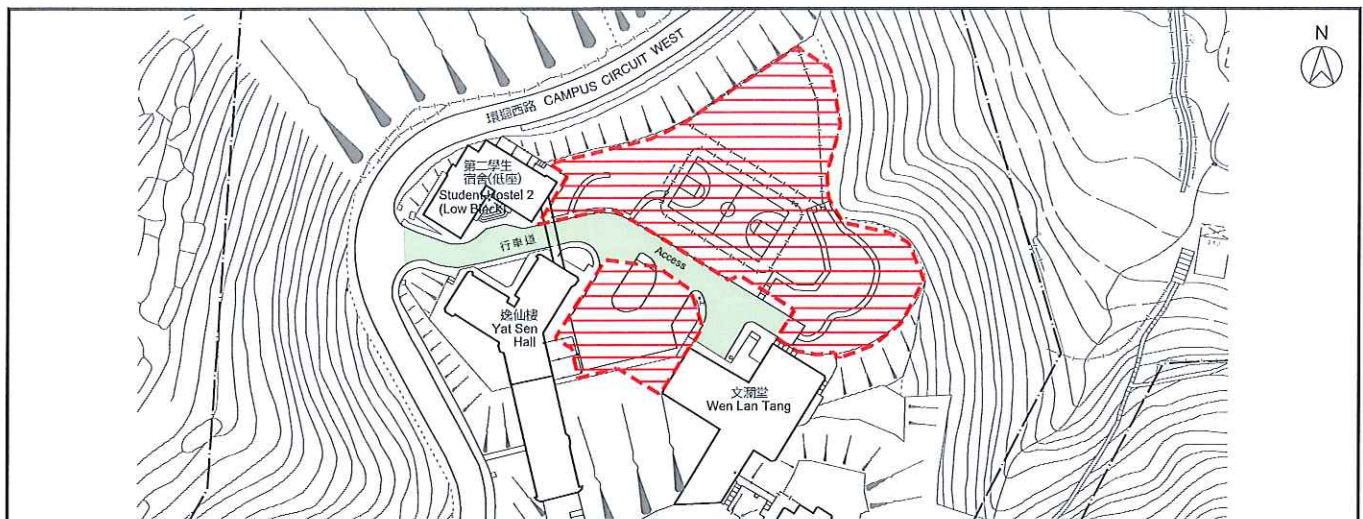

# Commencement of Main Contract Works for 300-Place Student Hostel at Shaw Campus



## Location Plan

1 : 1 000 (A3)

### Legend :

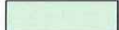
-  Site Area and Hoarding
-  Access to be Restricted

## GENERAL DESCRIPTION

### Notice of Construction of 300-Place Student Hostel

To facilitate the construction works of student hostel, hoarding will be erected at the site for the construction works from 1 August 2022 to 2nd Quarter 2025. The existing car park will be closed and the access will be restricted until completions of works.

Please refer to above diagram for the site location. We apologize for any inconvenience caused.

### 300-宿位學生宿舍工程通告

為配合學生宿舍工程, 工地將於 2022 年 8 月 1 日 至 2025 年 第二季期間加設圍板以便施工。現有停車場將會封閉及行車道將實施管制至工程完成。詳情請參閱上面位置圖。不便之處, 敬請原諒。

## PROJECT TEAM

### Responsible Office - Campus Development Office

Project Manager (Architect)	- Joyce Lau	(劉仲詩)	3943 6068
Project Engineer (B.S.)	- Holman Chong	(莊學文)	3943 6070
Clerk-of-Works (Builder)	- Kwok Kam Wing	(郭錦榮)	9658 0719
Clerk-of-Works (B.S.)	- Ivan Wong	(黃世雄)	9049 6322

### Architect - WCWP International Limited

Project Architect (Authorized Person)	- Kenny To	(杜沛家)	2893 3000
---------------------------------------	------------	-------	-----------

### Structural Engineer - Aurecon (Hong Kong) Limited

Structural Engineer	- Francis Yau	(尤耀晃)	3664 6888
---------------------	---------------	-------	-----------

### B.S. Engineer - Aurecon (Hong Kong) Limited

B.S. Engineer	- Mike Lee	(李智榮)	3664 6888
---------------	------------	-------	-----------

### Main Contractor - CR Construction Company Limited

Project Manager	- Lui Kei Fung, Frankie (呂其鋒)	9415 6352	*
-----------------	-------------------------------	-----------	---

\* 24 hours Emergency Contact

Work Period : 1 August 2022 - 2nd Quarter 2025